

WS36 - Repair Instructions

Fynspray WS36 - 1/2" Impeller Pump

- Grease the pump thoroughly before operating.
- Mount the pump as near as possible to the liquid being pumped and ensure that suction pipe and fittings are air tight.
- Pumps are self priming but rely on the liquids for lubrication and should not be run dry for more than 20 seconds.
- For best results do not run the pump at a higher speed than necessary, keeping within the range of 500 to 1750 rpm.
- For increased impeller life, pressures should be kept below 0.7 bar.
- The impeller is heat resistant and designed to run between 40°F and 180°F. In conditions where freezing takes place, care must be taken to drain the pump after use by loosening the cover plate.
- Petroleum derived cleaning solvents such as naphtha, kerosene, benzine etc, and carbon tetra-chloride, paint and lacquer thinners cannot be pumped satisfactorily. In some cases oils can cause swelling of the impeller causing binding.
- **DO NOT** hammer pulley on to the shaft as this will damage the pump internally.
DO NOT run pump dry for prolonged periods.
DO NOT install pump with over tight belt as this will reduce the bearing life.

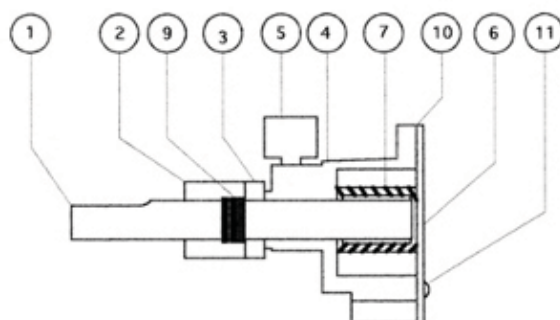

Part #	Qty	Description
WS 36-1	1	Shaft w/ key
WS 36-2	1	Gland Nut
WS 36-3	1	Lock Nut
WS 36-4	1	Body
WS 36-5	1	Grease Cup
WS 36-6	1	Cover Plate
WS 36-7	1	Impeller
WS 36-9	1	Gland Packing
WS 36-10	1	Gasket
WS 36-11	6	Screws

